

www.everest.al



EVEREST HEADQUARTERS

A: Bulevardi Blu 544, Kamëz, Tirana 1030,
AL (Tiranë, Kamëz, Fabrika në Rrugën
Nacionale, pranë Nyjes së Betonit)

T: +355 47 20 44 44

E: automotive@everest.al



AUTOMOTIVE INDUSTRY

IMPROVING YOUR COMFORT
WITH SMART SOLUTION

ABOUT US

Everest is one of the leading companies in manufacturing aluminum profiles in the region with more than 25 years of experience and with a fast-growing production capacity, thanks to the energy and passion for the work, the trustees and qualified staff, who make this company a reliable and safe partner for you.

Automotive Engineering.

Everest excels in producing automotive parts. The first quality of aluminum from our industry is used to create different components for automotive parts like car doors, cabins or roofs up until creation of ship parts including windows and more.





SMART SOLUTIONS IN AN ECO WAY

- ✓ - Green Energy
- ✓ - Build a better world with quality aluminum profiles.
- ✓ - Creating long-term solutions in aluminum Technology.

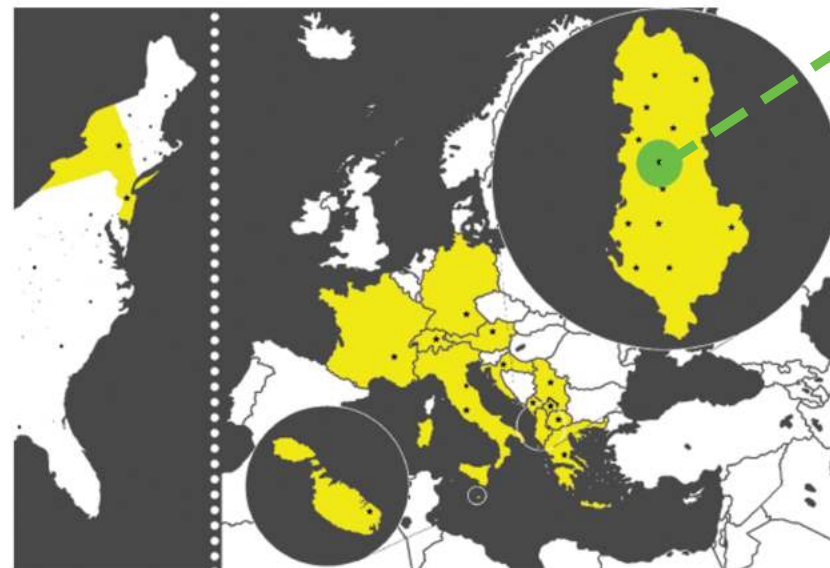

EVEREST LOCATION

TIRANE, ALBANIA (HEADQUARTERS)
PRISTINA, KOSOVO
PODGORICA, MONTENEGRO
REPUBLIC OF NORTH MACEDONIA
VALETTE, MALTA

NEW YORK, USA
MUNICH, GERMANY
ROME, ITALY





PRODUCTION PROCESSES AT EVEREST

- ALUMINUM SMELTING PROCESS & BILLET PRODUCTION
- ALUMINUM EXTRUSION PROCESS
- POWDER COATING
- ALUMINUM BENDING , MILLING, DRILLING & CUTTING
- ASSEMBLING & WELDING
- AUTOMOTIVE MANUFACTURING PROCESSES
- FINAL PRODUCTS
- NEW INVESTMENTS

RIVIAN.....08

JEEP.....10

RANGE ROVER.....12

MERCEDES- BENZ.....14

GOUPIL.....16

LINDE.....18

FOUNDRY RECYCLING ALUMINUM.....20

EXTRUSION.....22

POWDER COATING.....24

CHASSIS PRODUCTION26

CHASSIS PRODUCTION - PART 2.....28

SOLAR PANELS.....30





The R1T tailgate opens automatically and can be controlled through the app, fob, in-vehicle controls or a button on the bed rail. On the bed walls, forged steel tie-downs in each corner help strap in heavy cargo. On the bed rails above, there are four additional tie-downs that double as mounting points for our Cargo Crossbars. On the bed wall near the tailgate are two 15-amp, 120-volt plugs.

Two lockable tonneau cover options turn the entire bed into an extra 29 cubic feet of secure, weatherproof storage space. Our powered cover retracts using the app, in-vehicle controls or a button on the bed rail. Our manual cover is easily removed in four lightweight panels that can be stored in the Gear Tunnel. Both covers have been designed to support 4 feet of snow.



CLIENT: BOS



OEM: RIVIAN



RIVIAN

RIVIAN R1T



Electric Tonneau Cover

Everest Automotive extrudes different part numbers for the ETC product. The parts are then machined, powder coated, anodized and assembled at our production lines. We also produce different parts for the NoTC, MTC & Rivian's Kitchen system.





NEW JEEP GRAND CHEROKEE 2021 Chassis

Client GIL-MAR



OEM FCA



Extrusion!

The beloved Grand Cherokee ranks highest in owner loyalty, and now it's ready for tomorrow's next great adventures. The latest edition of the Most Awarded SUV Ever improves upon its legendary design with an available third row for more passengers and more fun. Plus, the All-New 2022 Jeep Grand Cherokee lineup offers an available 4xe plug-in hybrid electric motor that adds efficiency and incredible performance both on and off-road.



Aluminum has very good performance in strength and it is very light, which makes it a compatible material to be used in the chassis of the cars. Everest extrudes different part numbers made of hard alloys for these projects.

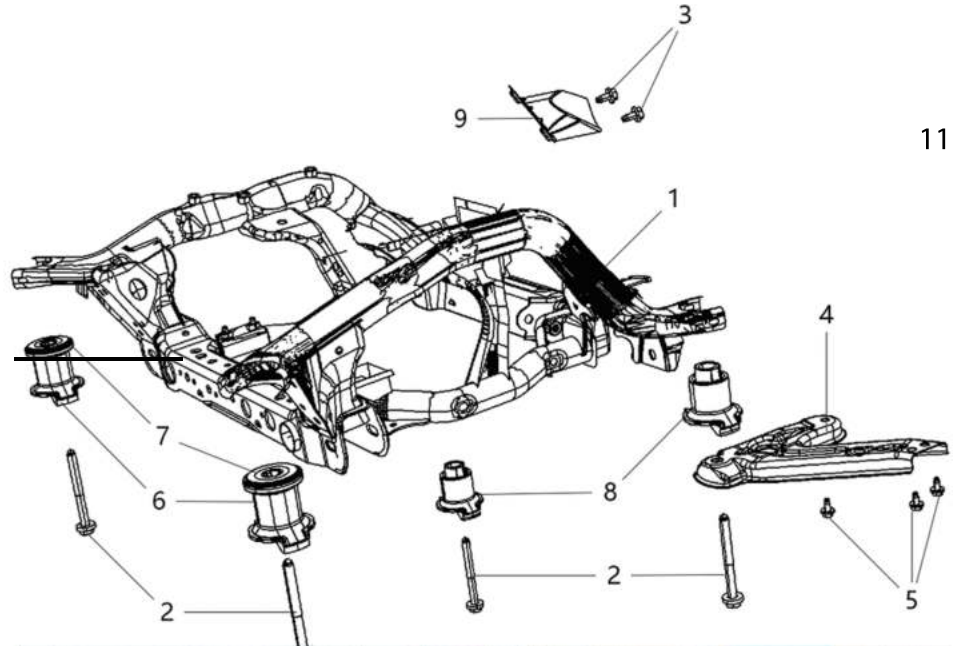



| RANGE ROVER

Customer



DRAXLMAIER

OEM



The luxury Range Rover SUV of its kind, it helped transform the world of refined motoring. With compelling design and greater levels of elegance, exclusivity and luxury, it leads by example. Range Rover possesses a unique skill set, including peerless refinement, cossetting comfort, and assured and confident on-road handling.





2022 Mercedes-Benz GLE-Class

Running Boards LH/RH



GLE Coupé was born to come out and conquer every corner of the earth. With its spectacular sporty design. With its revolutionary dashboard. With its fully active adjustability it can adapt to road conditions in fractions of a second.

- TECHNICAL SUPPORT
- LOGISTIC SUPPORT
- QUALITY INSPECTION SUPPORT



MERAXIS





ELECTRICAL UTILITY VEHICLE-ALUMINUM CABIN Polarys Door

The G4 offers a safe and comfortable working environment. The lightweight aluminium cab is protected with polypropylene bumpers and includes ABS glass front and rear screens with electric front wiper, screen wash and electric heated front windscreen.

Both driver and passenger have adjustable seats and padded adjustable headrests and afforded excellent all-round visibility with a rear cab window and fully glazed doors with views of pavement and kerb.

The instrument panel incorporates a high-definition LCD colour display which includes battery discharge indicator, digital speedometer, odometer and low-level warning lights.



LOCHMANN
cabin innovation

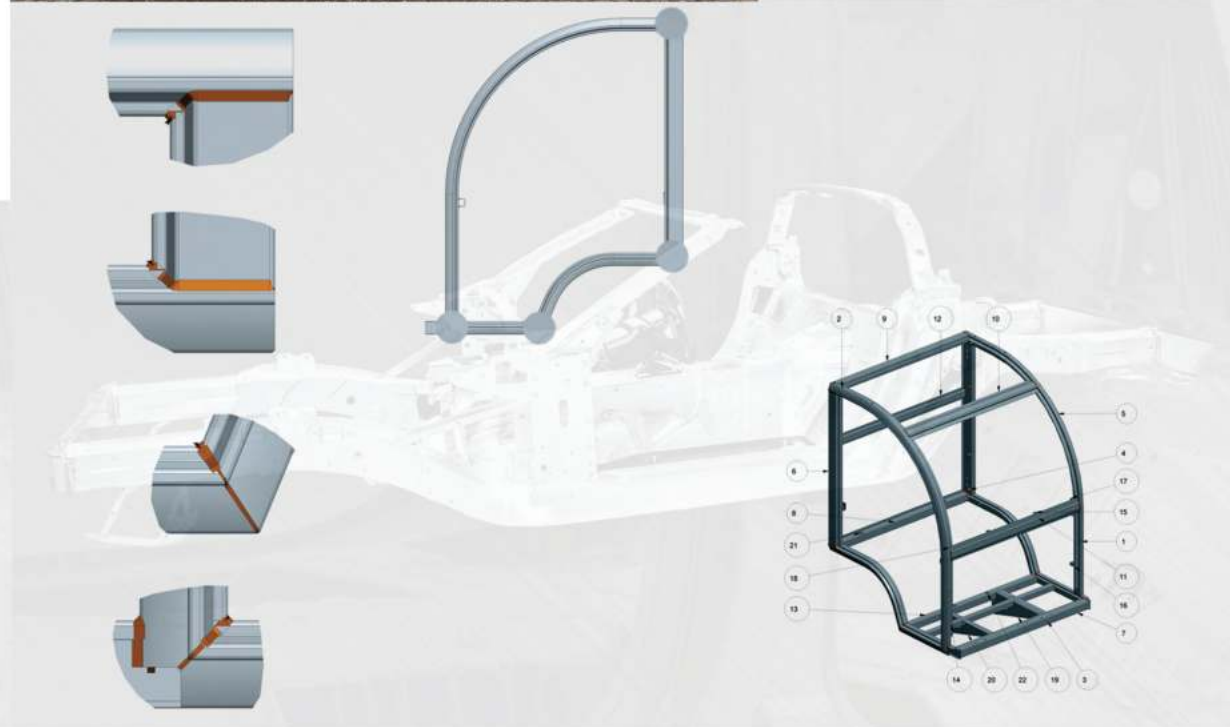

Polarys Door

EVEREST has been collaborating for four years with LOCHMAN CABINEN supplying door frames to OEM Group, vehicle G4-300 vehicles/Month



ALUMINUM RAILS

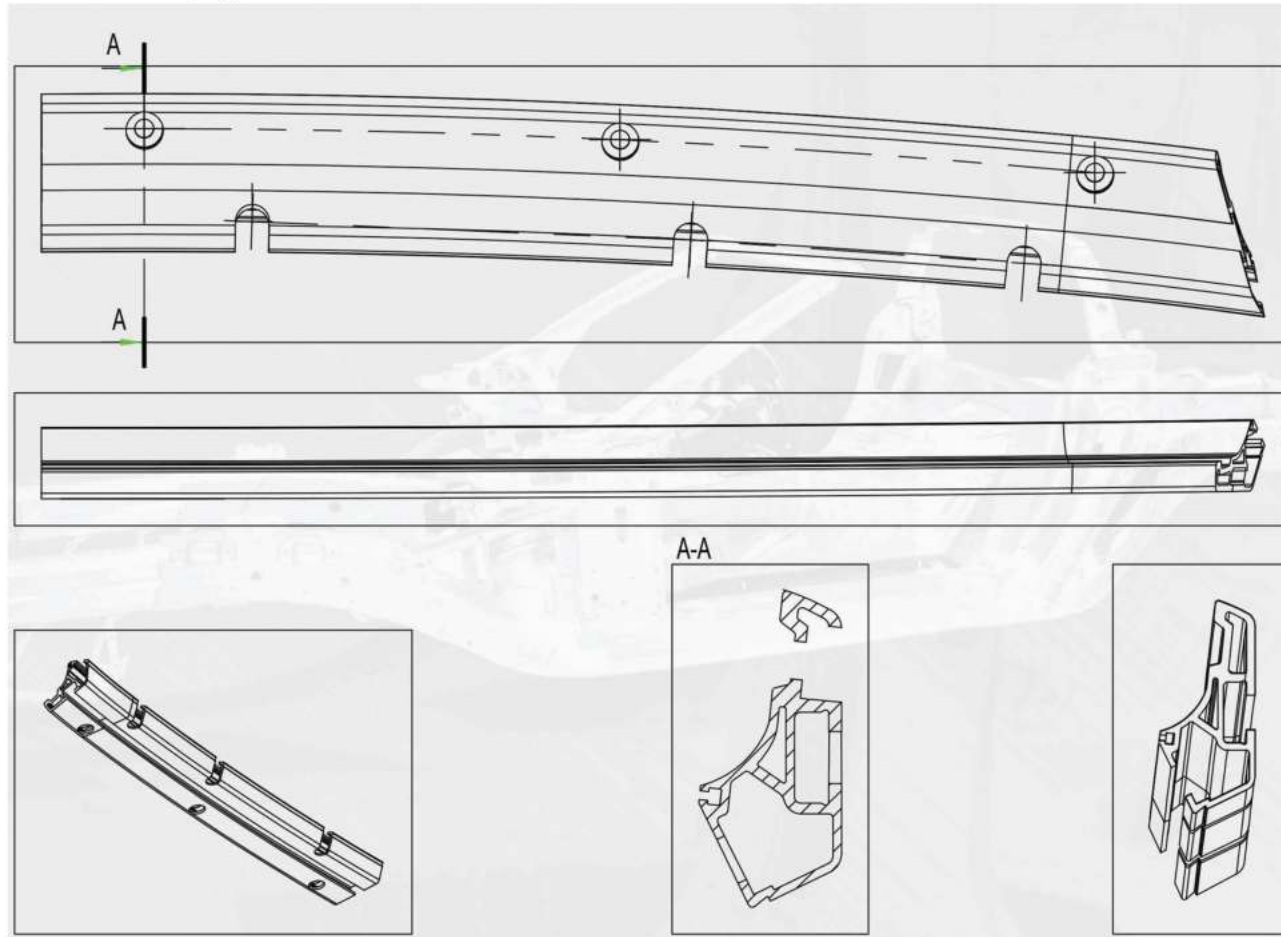

CLIENT:



OEM:



SAFETY

The Linde Protector Frame provides outstanding protection for the driver, surrounding them with a closed unit formed from the frame and roof. And in the H40 – H50 IC trucks, the driver also retains good all-round visibility, thanks to the slim profile of the lift mast and the overhead tilt cylinders which remain out of view. Linde Curve Assist prevents the truck moving at an excessive speed around bends, while brakes without a control delay and kickback-free steering assist the driver in better controlling the forklift. The impressive residual capacity guarantees excellent safety even when bearing heavy loads.



Foundry Recycling Aluminum



RECYCLE
REUSE
REDUCE



1. MELTING FURNACE ALUMINUM SCRAP

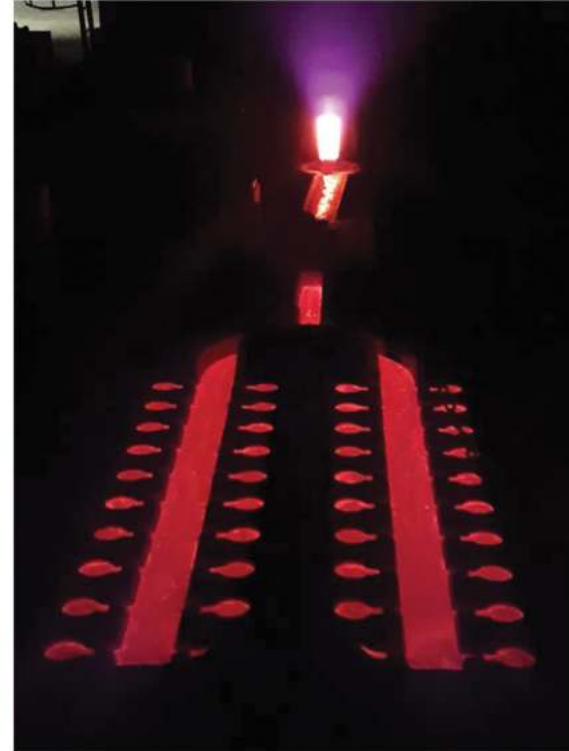

2. ALUMINUM CASTING

We currently use approximately 20-30% of recycled aluminum material.
In the Foundry's filtration system, 400 Aramide sleeves are used to make it possible to filter the fumes in order to have as few gas emissions as possible (which are within the



3. THE FINAL PRODUCT



Experience on production of 6060, 6063, 6082, 6061 and 6005 aluminum billets.
• Capability to produce chemical composition of aluminum billets based on standard EN573-3. (capability to produce personalized chemical composition aluminum billets)
• Capacity: 31m -Tons/ day
• The quality of the ticket is inspected by the ultrasound method.



4. Optical Emission Spectrometer

Automotive Extrusions Structural Parts



Extrusion of more than 1000 shapes of aluminum profiles based on european standards UNI EN 12020-2.
Experience on production of 6005, 6060 , 6063, 6082 and 6061 aluminum profiles.
Capability to extrude every kind of aluminum billet alloy.



Mechanical Properties: EN 755-2 (different aging cycles can be performed to achieve personalized mechanical properties)



ASCONA & TENSILE TESTING MACHINE
Dimensional Control of Profiles
Tensile, compression, flexure (one or two load points), bending, extrusion, penetration, shear, etc., on metallic and nonmetallic materials.





1. Vertical powder coating line



2. Horizontal powder coating line



THE PRODUCTION STANDARTS

We produce based on Qualicoat Standarts with three quality classes, with the following tests:

1. Machu test
2. Bending test (EN ISO 1519)
3. Paint gloss (EN ISO 2813)
4. Impact resistance (EN ISO 6272)
5. Cuter test (EN ISO 2409)
6. Thicness coating (EN ISO 2360)

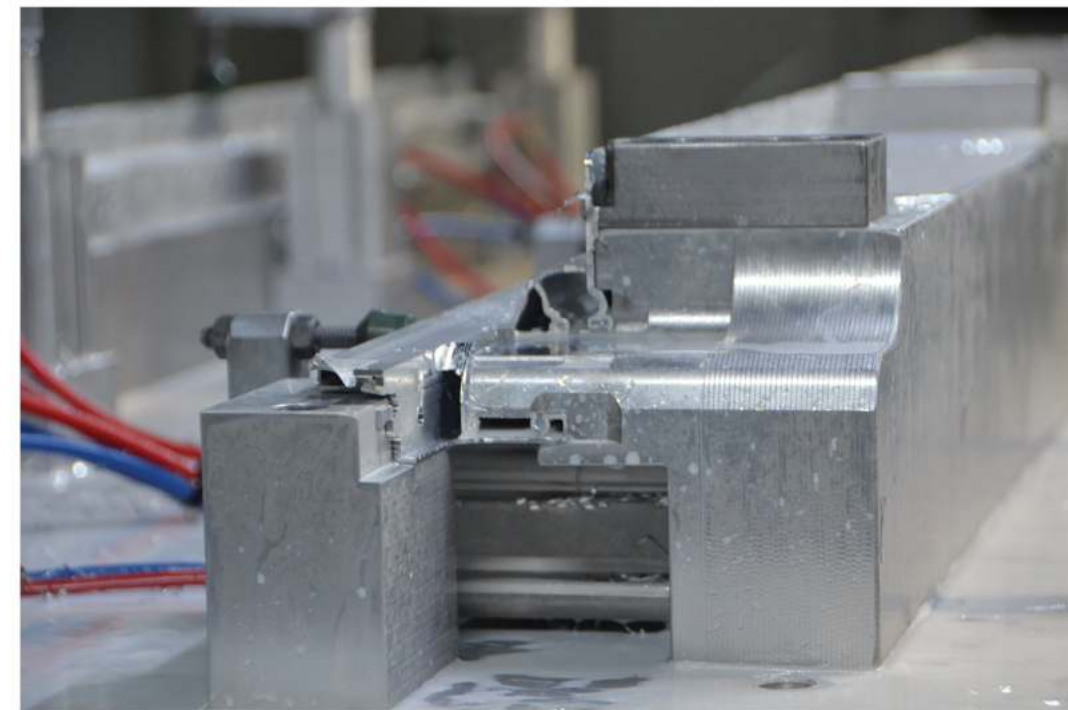

1. Vertical milling machine

MANUAL ASSEMBLING LINE



TIG WELDING

WELDING

BENDING

FARO QUANTUM E



SOLAR PANELS

Our monthly electricity consumption is an average of 300,000 KW. With the recent investment in the production of energy through Photovoltaic panels for days with maximum production capacity, we meet 70-80% of our consumption needs.